

Conceptual Drawing

The Beacon Street Rowhouse
2 Bedroom, 2.5 Bath, 1 Car Garage
By Touchstone Builders

These stately brick rowhouses showcase double bay windows and terraced front garden courtyards. Comprising an average of 1,435 heated square feet, each Beacon Street Rowhouse is well-appointed with hardwood flooring, custom cabinetry and extensive trim. Beacon Street is centrally located in the Village near shopping, restaurants & the YMCA. Presells are now underway for late Summer 2008 delivery.

From \$164,900
704.721.5263 • www.AftonVillage.com

number of stairway risers
vary depending on garage
to first floor elevation
change

1 Car Garage

1 Car Garage

Kitchen

Kitchen

Dining Area

Dining Area

Optional
Fireplace

Optional
Fireplace

Living Area

Living Area

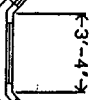
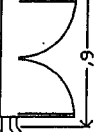

End Unit
1st Floor
Approx
742 Sq Ft

Interior
1st Floor
Approx
730 Sq Ft

End Unit Courtyard
Size and Shape Vary
Depending on Particular
Lot Conditions

Interior Unit Courtyard
Size and Shape Vary
Depending on Particular
Lot Conditions

25'-10"

25'-10"

15'-4 1/2"

15'-4 1/2"



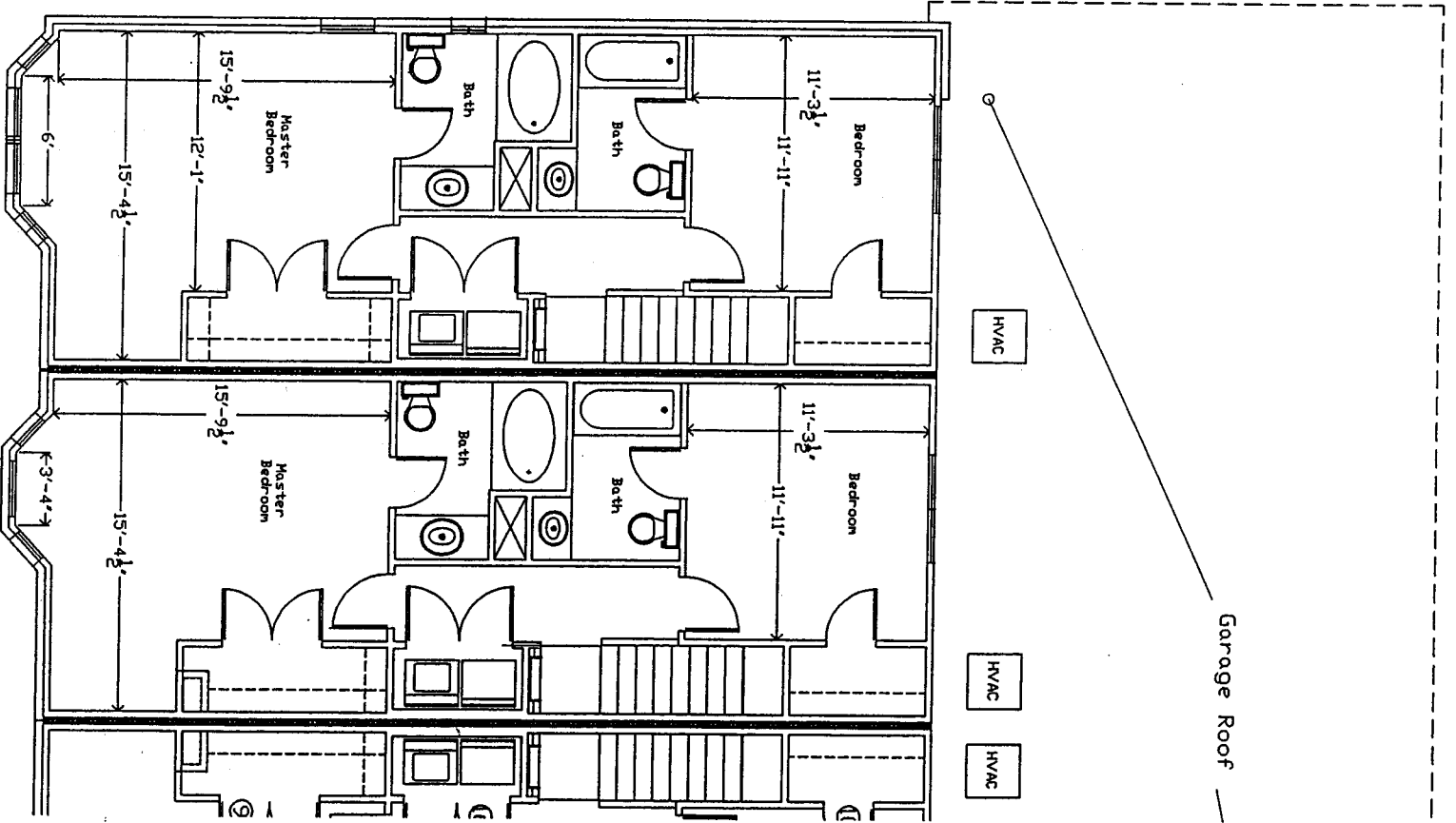

End Unit
2nd Floor
Approx
708 Sq Ft

Interior Unit
2nd Floor
Approx
693 Sq Ft